

dry.power

Sealed lead-acid battery



Product features

⇨ customer benefits

- Electrolyte fixed in glass mat
 - ⇨ no maintenance
 - ⇨ horizontal operation (option)
- Grid plate
 - ⇨ high energy density
- Wide range of dimensions and connection types
 - ⇨ versatile for use in consumer applications

Applications

- UPS
- IT/Telecom

dry.power Type Overview

Capacities, Dimensions and Weights

Type	C ₂₀ /1.75 V Ah	C _{1/2} /1.75 V Ah	C _{1/4} /1.70 V Ah	C _{1/6} /1.60 V Ah	Weight kg	Terminal Type	Length mm	Width mm	Height mm
dry.power 12 V 7 Ah	7.2	3.7	3.3	3.1	2.7	A	151	65	100
dry.power 12 V 12 Ah	12.0	6.3	5.5	5.0	4.1	A	151	98	100
dry.power 12 V 18 Ah	18.0	9.5	8.3	7.5	6.1	B	181	76	167
dry.power 12 V 25 Ah	26.0	13.7	12.0	10.9	8.8	B	166	175	125
dry.power 12 V 33 Ah	33.0	18.4	16.1	14.6	15.0	E (M5)	198	132	170
dry.power 12 V 40 Ah	40.3	21.0	18.4	16.7	15.0	B	197	165	170
dry.power 12 V 65 Ah	69.0	35.1	30.7	27.8	23.8	C	350	166	174
dry.power 12 V 100 Ah	100.0	52.5	46.0	41.8	34.0	E (M6)	329	172	221
dry.power 12 V 200 Ah	200.0	105.0	92.0	83.7	73.0	D	520	260	240

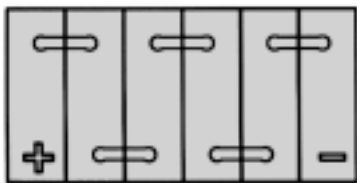
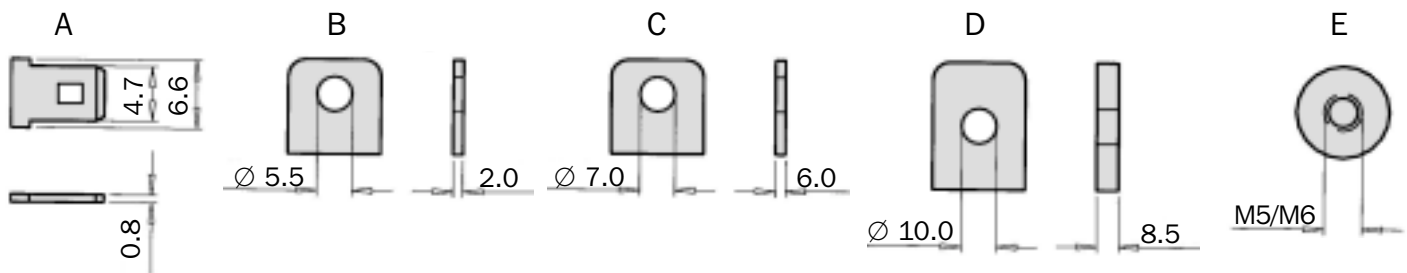

dry.power 12 V 18 Ah
 dry.power 12 V 33 Ah
 dry.power 12 V 40 Ah
 dry.power 12 V 65 Ah
 dry.power 12 V 100 Ah

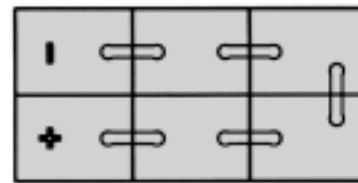

dry.power 12 V 7 Ah
 dry.power 12 V 12 Ah
 dry.power 12 V 25 Ah
 dry.power 12 V 200 Ah

Life expectancy: 3 - 5 years (acc. to EUROBAT)

Sales and Administration
HOPPECKE Batterien GmbH & Co. KG
 P.O.Box 1140 · D-59914 Brilon
 Bontkirchener Straße 1 · D-59929 Brilon-Hoppecke
 Phone + 49 29 63 61-3 74 · Fax + 49 29 63 61-2 70
 www.hoppecke.de · info@hoppecke.com

 **HOPPECKE**
POWER FROM INNOVATION